

**New!**

# Power Flue Wall Furnace

Ideal for heating the living area or entertainment spaces of your home, the Braemar Ecostar Power Flue Wall Furnace (PWF) delivers comfort and warmth throughout the cooler months. A great replacement for existing wall furnaces, with an energy efficiency of up to 4.5 stars.

The PWF utilises a powered flue system - safely expelling combustion emissions outside, leaving you in cosy warm comfort inside.

## Range

### Braemar Ecostar Power Flue PWF30

The PWF30 is a functional and stylish replacement for existing wall furnaces and is able to heat up to 95m<sup>2</sup>.\*

### Braemar Ecostar Power Flue PWF40 (commercial applications only)

The PWF40 will heat an approximate area of 80 - 120m<sup>2</sup>\* and is recommended for light commercial or very large domestic applications such as halls and large rumpus rooms. It is not suitable for smaller domestic applications due to the higher heat and air flow rates.

## Features

- Overheat safety switches
- Thermostatic temperature control
- Self diagnostic control system
- Cool-to-touch cabinet
- Pre-heat function
- Soft-air function
- Child lock
- Inbuilt and console models
- PWF30 - natural gas and propane
- PWF40 - natural gas only
- Multiple fan speeds
- Electronic ignition
- Electronic flame sensing
- Power flue
- Dual gas rate
- Boost setting for rapid heating



### Safety

No emissions inside with ultra-safe power flued heating



### Have it your way

Stylish design with flexible installation options

## Option to heat two rooms

Installing your wall furnace on an internal wall? An optional rear register kit means an adjoining room can also be heated.



### Quiet Operation

\*Refer to page 2 for technical specifications.

## Technical specifications

Model	Dimensions (mm)				Star rating	Gas input (MJ/hr)		Heat output kW	Area that can be heated (m <sup>2</sup> )		
	H	W	D (inbuilt)	D (console)		Low	High		Cold	Cool	Mild
Ecostar Power Flue PWF30	2050	498	167	260	4.5	20	28	6.4	65	85	95
Ecostar Power Flue PWF40	2050	498	167	260	4.2	25	38	8.6	80	100	120

\*Area that can be heated is an indication only and is based on brick veneer construction, insulated walls and ceilings, 2.4m ceiling height and suitable window coverings. A heat load calculation for the intended installation should be undertaken to determine the correct unit required for your specific application.

## Flexible installation options

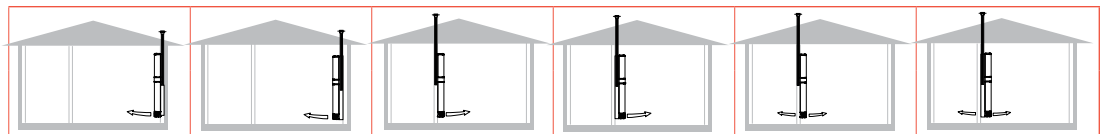

	Install location Install type Flue type Rear register	External wall Inbuilt	External wall Console	Internal wall Inbuilt	Internal wall Console	Internal wall Inbuilt	Internal wall Console
		Vertical flue NA	Vertical flue NA	Vertical flue No	Vertical flue No	Vertical flue Yes	Vertical flue Yes
PWF30 PWF40	Horizontal flue kit	-	-	-	-	-	-
	Vertical flue kit	077956	077956	077956	077956	077956	077956
	Console kit - standard	-	080789	-	080789	-	080789
	Console kit - long	-	080796	-	080796	-	080796
	Rear register kit	-	-	-	-	085142	085142

Console kit - standard: up to 3.3m ceiling height  
Console kit - long: up to 4.0m ceiling height

## Warranty

Braemar space heaters and wall furnaces are backed by a 2 year warranty and 10 year heat exchanger warranty.



For more information contact

**AIR DIFFUSION AGENCIES**  
[www.airdiffusion.com.au](http://www.airdiffusion.com.au)

